

Rivet Nut & Stud Hand Installation Tool

Note: To be assembled upright (orientate as per diagram)

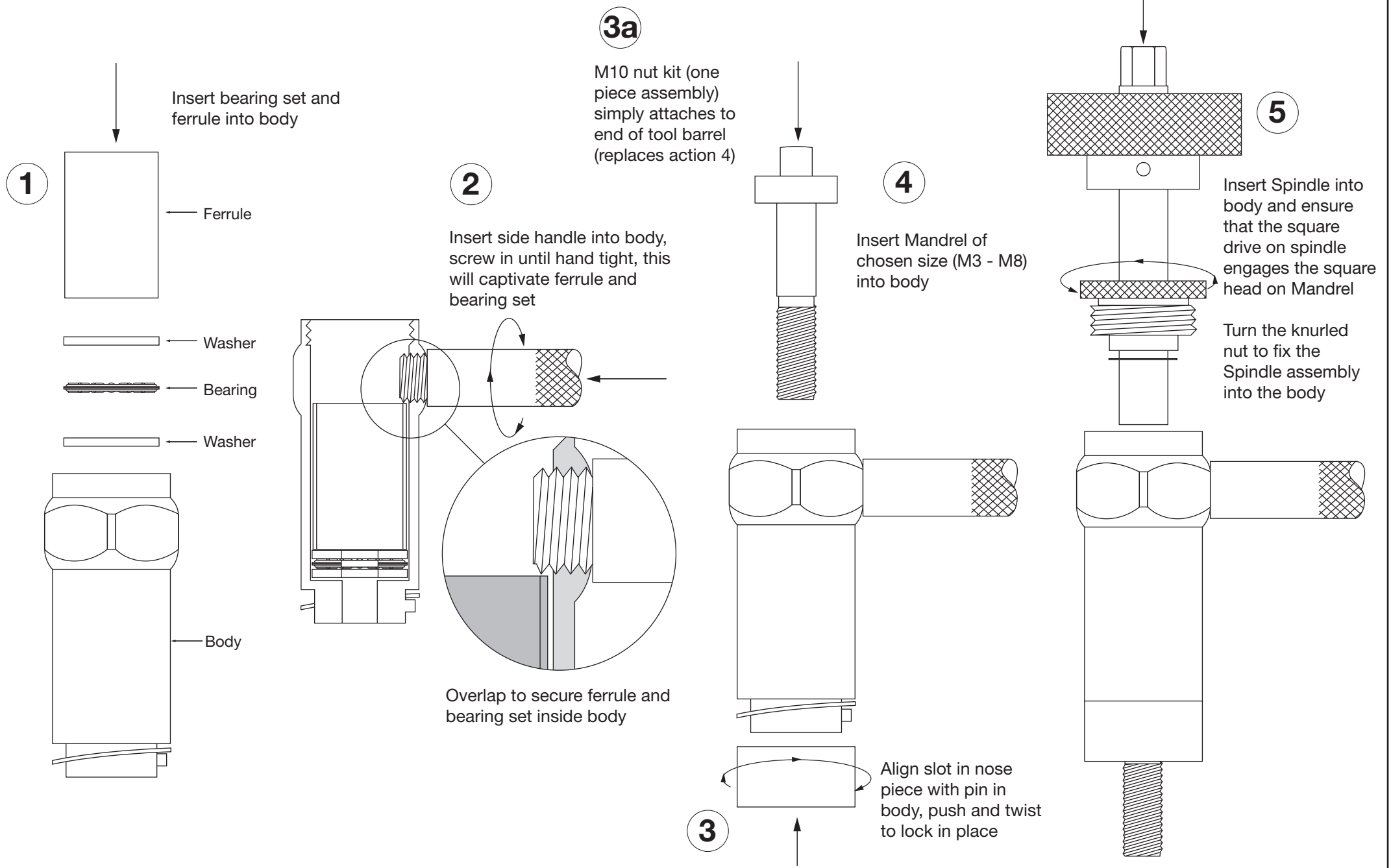

Note: Top 10mm Hex can be used to apply spanner/wrench to assist with larger sizes

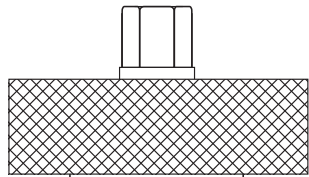

Push Spindle into body and ensure that the square drive on spindle engages the square head on Mandrel

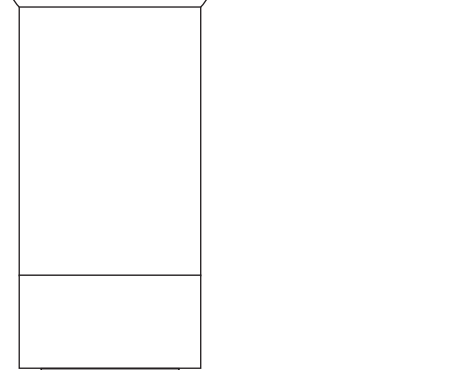
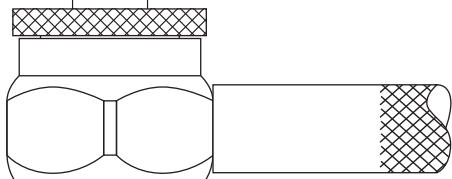

Screw Rivet Nut onto thread at the base of the body, tighten till hand tight

6

7

Drill appropriate hole size for the Rivet Nut used into the receiving base panel/sheet

Insert the Rivet Nut on the end of the body into the drilled hole

Turn the Knurled knob clockwise as many times as is necessary to achieve the effect shown below

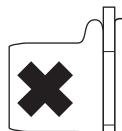
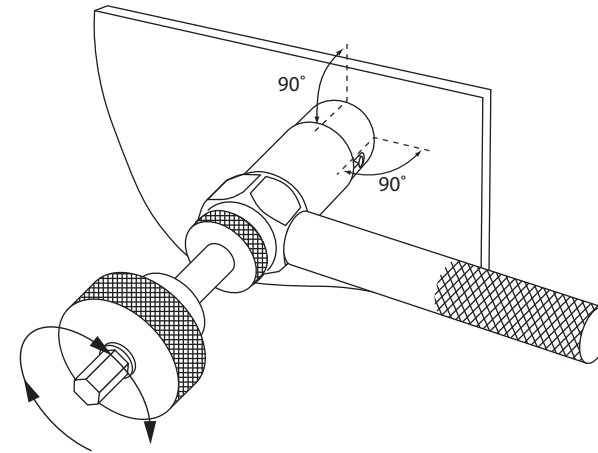

Too many turns

In danger of weakening the Rivet Nut and snapping the Mandrel



Correct number of turns

The Rivet Nut is tight in the hole and will not turn



Too few turns

Rivet Nut will be loose and will not be effective

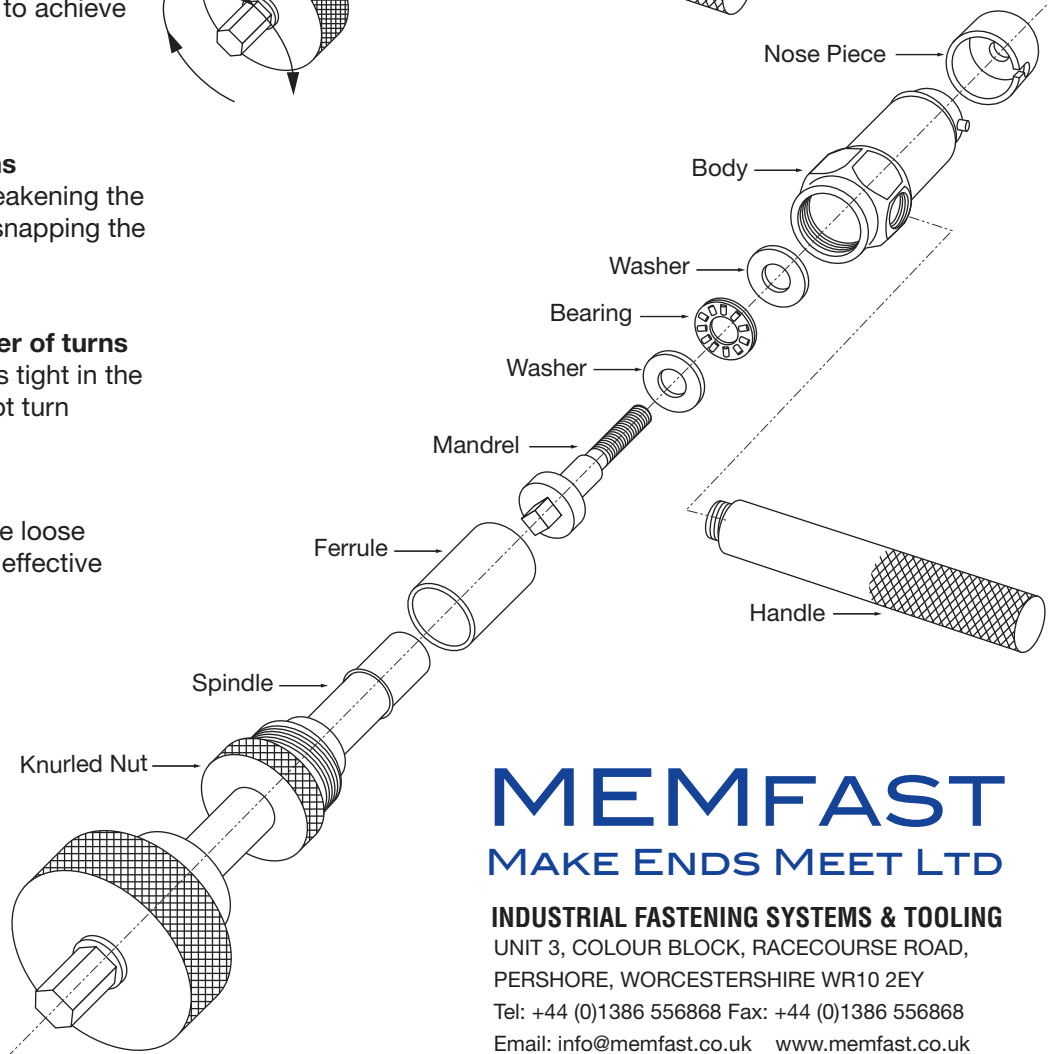

MEMFAST
MAKE ENDS MEET LTD

INDUSTRIAL FASTENING SYSTEMS & TOOLING

UNIT 3, COLOUR BLOCK, RACECOURSE ROAD,
PERSHORE, WORCESTERSHIRE WR10 2EY

Tel: +44 (0)1386 556868 Fax: +44 (0)1386 556868

Email: info@memfast.co.uk www.memfast.co.uk